



HALF HORSE

user manual

The **Half Horse** is a versatile overdrive pedal that combines classic tones with modern flexibility. It delivers smooth, musical distortion, with a focus on the midrange, giving your sound presence and warmth.

gain

The Gain Stage is driven by two NOS Germanium diodes, enabling a range from soft to hard clipping. Start at 7 o'clock and gradually turn it clockwise to find the gain level you prefer.

tone

The tone control is active. It cuts or boosts frequencies above 400 Hz. Start at 12 o'clock for a neutral setting. Turn clockwise to boost or counterclockwise to attenuate.

volume

As simple as it sounds, the volume pot will level the output signal. Start at 12 o'clock and find the right volume that fits your setup. You can also try using the pedal as a boost with the gain level set to zero.

In this fully analog circuit, each knob has a unique effect on the sound, and the way they interact with each other provides a multitude of possibilities for tone shaping. By adjusting the different knobs, you can explore a wide range of sounds until you find the one that matches your preferences. Don't hesitate to experiment and try different combinations, as it can lead to exciting results. Also make sure to check our website for demonstration videos.

mode switch

CL mode:

The classic mode delivers a familiar, balanced overdrive sound, perfect for vintage enthusiasts and guitarists who appreciate a smooth, dynamic tone. Switching the pedal on will light up the LED in **red**.

SE mode:

This modification provides more volume and added punch without altering the core character of the pedal. Switching the pedal on will light up the LED in **blue**.

The switch circuit is not designed to be used while playing. You may hear a 'plop' when using the slide switch. It is better to use the switch while the pedal is in bypass mode.

power

Please use only a standard pedal power supply with center-negative polarity. You must plug in the jack cables to activate the pedal.

It is strongly recommended to **use grounded power supplies** to prevent hum. The pedal features a microcontroller for the switching matrix and should preferably not be operated together with other pedals in a **daisy-chain power setup**.

When connecting through a mixer, audio interface, or PC, ground loops may occur, in which case a non-grounded power supply may be required. Otherwise, the use of non-grounded power supplies should **generally be avoided**.

technical data

True Bypass	Yes
Switch Typ	Soft Switch momentary
Length	113mm
Width	92mm (96mm incl. jacks)
Height	36mm (54mm incl. footswitch)
Weight	630g
Voltage	9V DC (center-negative)
Current	140mA (9V only)
Power supply included	No
Battery compartment	No

RoHS Compliant
CE (EU) Compliant
Designed and assembled in Germany

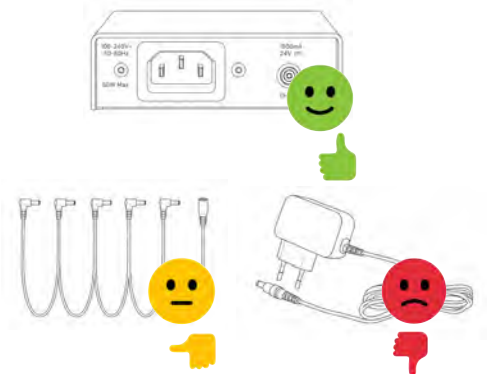

The user is responsible for any injuries or damages that may result from the incorrect use of this electronic product.